

Metināmi adapteri ar ORFS ārējo vītņi un iedobi

Welding adaptor male ORFS

Приварной коннектор с внешней ORFS резьбой

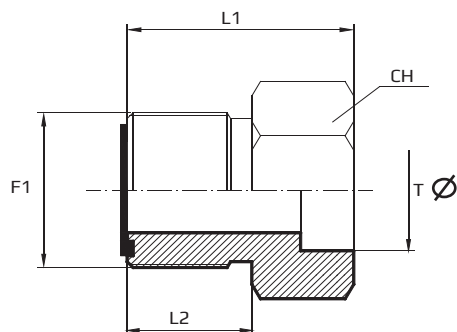

F1 ORFS  
T Ø

Kods Code Код	Vītne Thread Резьба	Izmēri Dimensions Размеры					PN Bar	
		F1	T mm	Ø mm	L1 mm	L2 mm		CH mm
AMNSO06T6	9/16		6	1/4	22	10	17	630
AMNSO09T10	11/16		10	3/8	23	11	19	630
AMNSO11T12	13/16		12	1/2	24.5	13	22	630
AMNSO13T16	1		16	5/8	28	15.5	27	420
AMNSO14T20	1.3/16		20	3/4	33.5	17	32	420
AMNSO15T25	1.7/16		25	1	38.5	17.5	41	420
AMNSO21T30	1.11/16		30	1.1/4	38.5	17.5	46	280
AMNSO32T38	2		38	1.1/2	38.5	17.5	55	280
AMNSO06T8	9/16		8	5/16	22	10	17	630
AMNSO06T10	9/16		10	3/8	22	10	17	630
AMNSO06T12	9/16		12	1/2	22	10	19	630
AMNSO09T6	11/16		6	1/4	23	11	19	630
AMNSO09T8	11/16		8	5/16	23	11	19	630
AMNSO09T12	11/16		12	1/2	23	11	19	630
AMNSO09T14	11/16		14	-	23.5	11	22	420
AMNSO09T15	11/16		15	-	23.5	11	22	420
AMNSO09T16	11/16		16	5/8	23.5	11	22	420
AMNSO11T6	13/16		6	1/4	24.5	13	22	630
AMNSO11T8	13/16		8	5/16	24.5	13	22	630
AMNSO11T10	13/16		10	3/8	24.5	13	22	630
AMNSO11T14	13/16		14	-	25	13	22	420
AMNSO11T15	13/16		15	-	25	13	22	420

Metināmi adapteri ar ORFS ārējo vītņi un iedobi

Welding adaptor male ORFS

Приварной коннектор с внешней ORFS резьбой

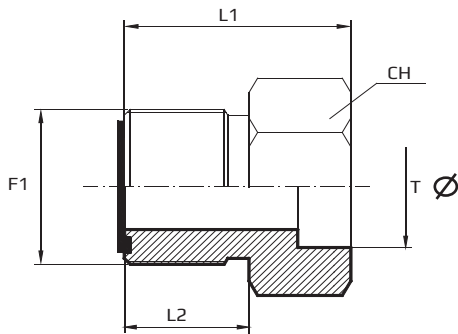

F1 ORFS  
T Ø

**Kods**  
Code  
Код

**Vītne**  
Thread  
Резьба

**Izmēri**  
Dimensions  
Размеры

	F1	T mm	Ø mm	L1 mm	L2 mm	CH mm	PN Bar
AMNSO11T16	13/16	16	5/8	25	13	22	420
AMNSO11T18	13/16	18	-	28.5	13	27	420
AMNSO11T20	13/16	20	3/4	28.5	13	27	420
AMNSO11T22	13/16	22	7/8	28.5	13	32	420
AMNSO11T25	13/16	25	1	30	13	32	420
AMNSO13T10	1	10	3/8	27.5	15.5	27	420
AMNSO13T12	1	12	1/2	27.5	15.5	27	420
AMNSO13T14	1	14	-	28	15.5	27	420
AMNSO13T15	1	15	-	28	15.5	27	420
AMNSO13T18	1	18	-	31.5	15.5	27	420
AMNSO13T20	1	20	3/4	31.5	15.5	27	420
AMNSO14T12	1.3/16	12	1/2	29.5	17	32	420
AMNSO14T14	1.3/16	14	-	30	17	32	420
AMNSO14T15	1.3/16	15	-	30	17	32	420
AMNSO14T16	1.3/16	16	5/8	30	17	32	420
AMNSO14T18	1.3/16	18	-	33.5	17	32	420
AMNSO14T22	1.3/16	22	7/8	33.5	17	32	420
AMNSO14T25	1.3/16	25	1	35	17	32	420
AMNSO15T12	1.7/16	12	1/2	33	17.5	41	420
AMNSO15T14	1.7/16	14	-	33.5	17.5	41	420
AMNSO15T15	1.7/16	15	-	33.5	17.5	41	420
AMNSO15T16	1.7/16	16	5/8	33.5	17.5	41	420

Metināmi adapteri ar ORFS ārējo vītņi un iedobi

Welding adaptor male ORFS

Приварной коннектор с внешней ORFS резьбой

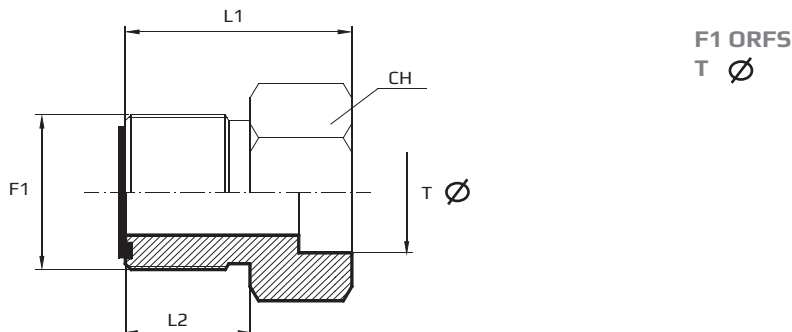

Kods Code Код	Vītne Thread Резьба	Izmēri Dimensions Размеры						
	F1	T mm	Ø mm	L1 mm	L2 mm	CH mm	PN Bar	
AMNSO15T18	1.7/16	18	-	37	17.5	41	420	
AMNSO15T20	1.7/16	20	3/4	37	17.5	41	420	
AMNSO15T22	1.7/16	22	7/8	37	17.5	41	420	
AMNSO15T28	1.7/16	28	-	38.5	17.5	41	280	
AMNSO15T30	1.7/16	30	1.1/4	38.5	17.5	41	280	
AMNSO15T32	1.7/16	32	-	38.5	17.5	41	280	
AMNSO21T18	1.11/16	18	-	37	17.5	46	280	
AMNSO21T20	1.11/16	20	3/4	37	17.5	46	280	
AMNSO21T22	1.11/16	22	7/8	37	17.5	46	280	
AMNSO21T25	1.11/16	25	1	38.5	17.5	46	280	
AMNSO21T28	1.11/16	28	-	38.5	17.5	46	280	
AMNSO21T32	1.11/16	32	-	38.5	17.5	46	280	
AMNSO21T35	1.11/16	35	-	38.5	17.5	50	280	
AMNSO21T38	1.11/16	38	1.1/2	38.5	17.5	50	280	
AMNSO32T25	2	25	1	38.5	17.5	55	280	
AMNSO32T28	2	28	-	38.5	17.5	55	280	
AMNSO32T30	2	30	1.1/4	38.5	17.5	55	280	
AMNSO32T32	2	32	-	38.5	17.5	55	280	
AMNSO32T35	2	35	-	38.5	17.5	55	280	