

Taisni adapteri ar kustīgu JIC iekšējo un UNF ārējo vītņi

Adaptor swivel female JIC - male UNF

Коннектор с подвижной JIC внутренней и UNF внешней резьбами

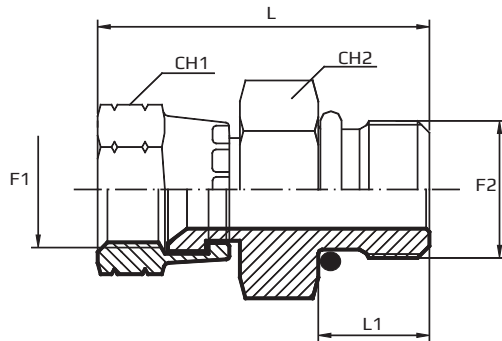

F1 JIC  
F2 UNF

Kods Code Код	Vītne Thread Резьба		Izmēri Dimensions Размеры				PN Bar
	F1	F2	CH1 mm	CH2 mm	L1 mm	L mm	
<b>AFGJ04MU04</b>	7/16"	7/16"	15	14	9.1	34.5	310
<b>AFGJ04MU05</b>	7/16"	1/2"	15	17	9.1	34.5	275
<b>AFGJ04MU06</b>	7/16"	9/16"	15	17	10	36.5	275
<b>AFGJ05MU05</b>	1/2"	1/2"	17	17	9.1	36	275
<b>AFGJ06MU06</b>	9/16"	9/16"	19	17	10	38.8	275
<b>AFGJ06MU08</b>	9/16"	3/4"	19	22	11.1	40.8	275
<b>AFGJ08MU08</b>	3/4"	3/4"	24	22	11.1	43.1	275
<b>AFGJ08MU10</b>	3/4"	7/8"	24	27	12.7	46.1	210
<b>AFGJ08MU12</b>	3/4"	1".1/16	24	32	15.1	50.1	210
<b>AFGJ10MU08</b>	7/8"	3/4"	27	22	11.1	47.1	210
<b>AFGJ10MU10</b>	7/8"	7/8"	27	27	12.7	50.1	210
<b>AFGJ10MU12</b>	7/8"	1".1/16	27	32	15.1	54.1	210
<b>AFGJ12MU08*</b>	1".1/16	3/4"	32	27	11.1	48.7	210
<b>AFGJ12MU10*</b>	1".1/16	7/8"	32	27	12.7	50.2	210
<b>AFGJ12MU12*</b>	1".1/16	1".1/16	32	32	15.1	54.1	210
<b>AFGJ12MU16*</b>	1".1/16	1".5/16	32	41	15.1	54.7	170
<b>AFGJ16MU12*</b>	1".5/16	1".1/16	41	32	15.1	57.9	170
<b>AFGJ16MU16*</b>	1".5/16	1".5/16	41	41	15.1	54.7	170
<b>AFGJ16MU20*</b>	1".5/16	1".5/8	41	50	15.1	60.4	140
<b>AFGJ20MU20*</b>	1".5/8	1".5/8	50	50	15.1	60.8	140
<b>AFGJ24MU24*</b>	1".7/8	1".7/8	55	55	15.1	69.8	105