

Taisni adapteri ar kustīgu JIC iekšējo un BSP (collīgo) ārējo vītņi

Adaptor swivel female JIC - male BSPP form E

Коннектор с подвижной JIC внутренней и дюймовой внешней резьбами

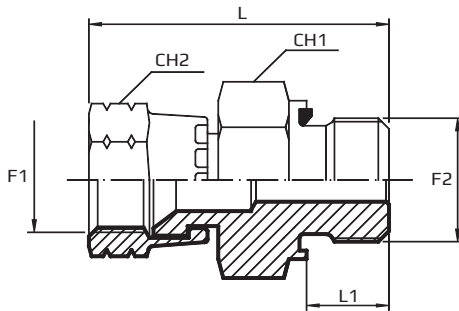

F1 JIC
F2 BSPP

Kods
Code
Code

Vītne
Thread
Резьба

Izmēri
Dimensions
Размеры

Kods Code Code	Vītne Thread Резьба		Izmēri Dimensions Размеры				PN Bar
	F1	F2	CH1 mm	CH2 mm	L1 mm	L mm	
AFGJ04MG02R	7/16"	1/8"	14	15	8	34	310
AFGJ04MG04R	7/16"	1/4"	19	15	12	37.5	275
AFGJ04MG06R	7/16"	3/8"	22	15	12	39.5	275
AFGJ05MG02R	1/2"	1/8"	14	17	8	35.5	275
AFGJ05MG04R	1/2"	1/4"	19	17	12	39	275
AFGJ05MG06R	1/2"	3/8"	22	17	12	41	210
AFGJ06MG04R	9/16"	1/4"	19	19	12	39.8	275
AFGJ06MG06R	9/16"	3/8"	22	19	12	41.8	210
AFGJ06MG08R	9/16"	1/2"	27	19	14	45.3	210
AFGJ08MG04R	3/4"	1/4"	19	24	12	42.1	275
AFGJ08MG06R	3/4"	3/8"	22	24	12	44.1	275
AFGJ08MG08R	3/4"	1/2"	27	24	14	47.6	210
AFGJ10MG06R	7/8"	3/8"	22	27	12	48.1	210
AFGJ10MG08R	7/8"	1/2"	27	27	14	51.6	210
AFGJ10MG12R	7/8"	3/4"	32	27	16	55.1	210
AFGJ12MG08R*	1".1/16	1/2"	27	32	14	51.7	210
AFGJ12MG12R*	1".1/16	3/4"	32	32	16	55.2	210
AFGJ12MG16R*	1".1/16	1"	41	32	18	58.7	170
AFGJ16MG12R*	1".5/16	3/4"	32	41	16	58.9	170

Taisni adapteri ar kustīgu JIC iekšējo un BSP (collīgo) ārējo vītņi

Adaptor swivel female JIC - male BSPP form E

Коннектор с подвижной JIC внутренней и дюймовой внешней резьбами

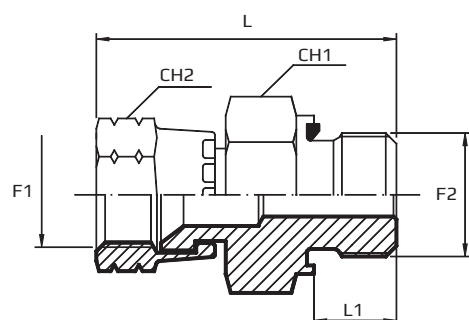

F1 JIC
F2 BSPP

Kods Code Код	Vītne Thread Резьба		Izmēri Dimensions Размеры				PN Bar
	F1	F2	CH1 mm	CH2 mm	L1 mm	L mm	
AFGJ16MG16R*	1".5/16	1"	41	41	18	62	170
AFGJ16MG20R*	1".5/16	1".1/4	50	41	20	66.9	170
AFGJ20MG16R*	1".5/8	1"	41	50	18	62.8	140
AFGJ20MG20R*	1".5/8	1".1/4	50	50	20	67.3	140
AFGJ24MG20R*	1".7/8	1".1/4	50	55	20	74.3	105
AFGJ24MG24R*	1".7/8	1".1/2	55	55	26	77.5	105